

***NS***

# Pro Film Carrier 35

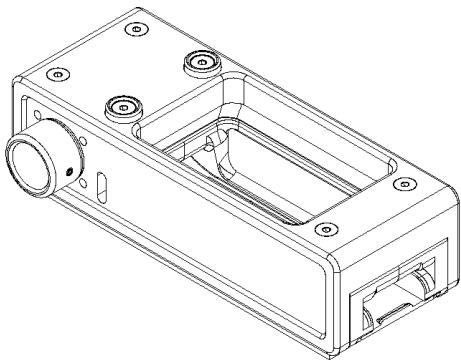

At Negative Supply, we believe in providing tools for working photographers and enthusiasts. Our ecosystem of film scanning products are used by thousands of individuals, institutions, and film labs across the globe. The Pro Film Carrier 35 builds on our mission of creating the very best analog tools available and provides an even better experience for scanning 35mm film.

Some features at a glance:

- Capable of scanning standard, half frame, and panoramic frames in a single capture with included masks
- Modular design with replaceable internal cassette for future updates and accessories
- Hybrid compatibility with existing Pro and Basic products
- Tighter, flatter, and smoother film advancement with updated mechanism

# What's In The Box:

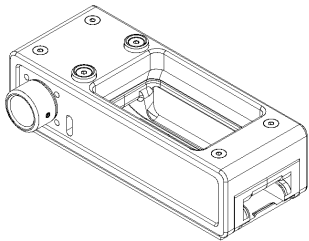

Pro Film Carrier 35

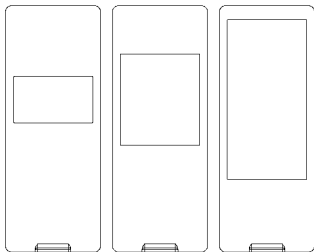

Standard Cassette  
Masks



2mm Hex Key

## How To Use:

Insert your film curved side down into your Pro Film Carrier 35 (lettering should be facing you). Once you have inserted your film, continue inserting to the point that the film advance knob can engage with your film. Rotate knob clockwise to advance the film strip.

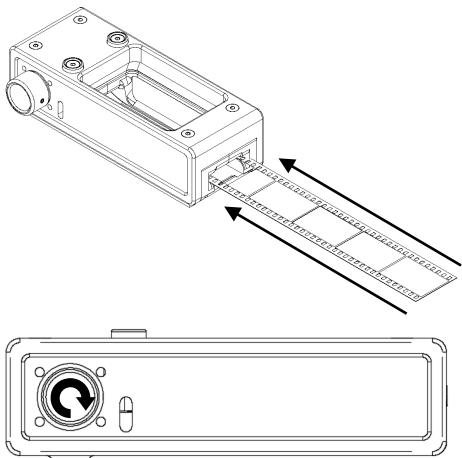

## How To Change Masks:

Grab the lip of the inserted mask and slide out horizontally. Insert appropriate mask for intended format. Ensure the lip of the mask is oriented upwards.

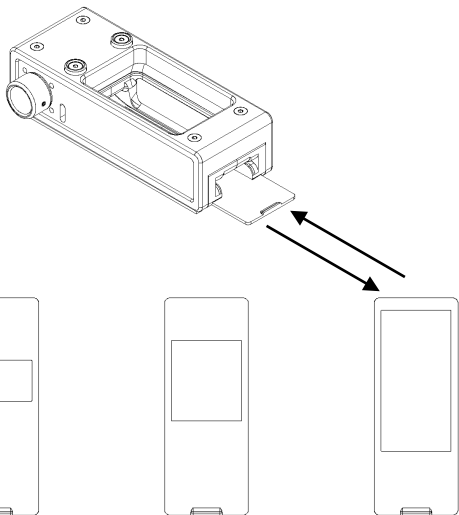

Half Frame

Standard

Pano

# Pro Line Compatibility

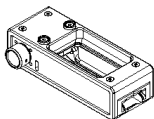

Pro Film Carrier 35

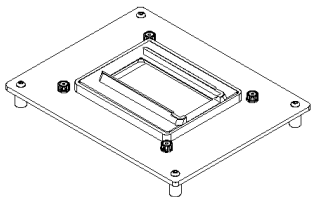

Pro Mount MK2  
w/ adapter plate

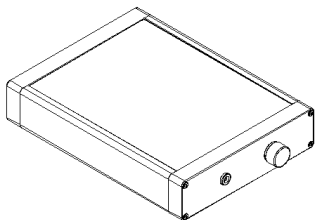

5x7 Light Source  
Pro

# Basic Line Compatibility

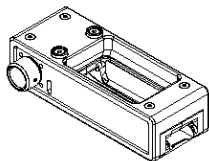

Pro Film Carrier 35

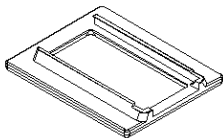

Basic Adapter Plate

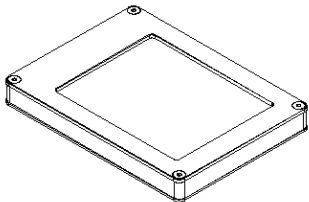

4x5 Light Source  
Basic



Thank you for choosing Negative Supply!

If you have any questions or concerns,  
feel free to contact us.

[contact@negativesupply.co](mailto:contact@negativesupply.co)

<https://www.negative.supply>

